

Makita Cordless Vacuum Cleaner 18V

A highly portable Cordless Vacuum Cleaner powered by an 18V Lithium-Ion battery. Ideal for commercial cleaning applications including shops, offices, homes, worksites and vehicles.



Machine Specifications

Capacities	Volume	3.0 L
	Max. Air Volume	3.4 m³/min
Continuous use (approx.)	HIGH	6 min (with BL1815)
		7 min (with BL1815N)
		8 min (with BL1820)
		13 min (with BL1830)
		18 min (with BL1840)
		21 min (with BL1850)
	LOW	12 min (with BL1815)
		14 min (with BL1815N)
		16 min (with BL1820)
		26 min (with BL1830)
		36 min (with BL1840)
		42 min (with BL1850)
Overall length		403 mm
Rated Voltage		18 V
Weight	2.2 kg (BL1815/BL1815N/BL1820)	
	2.4 kg (BL1830/BL1840/BL1850)	

User Benefits

- Soft start
- Electronic 2-speed selection
- Shoulder belt can be easily slung over the shoulder for added mobility
- 2 functions in one machine – convertible into a blower by attaching nozzle assembly

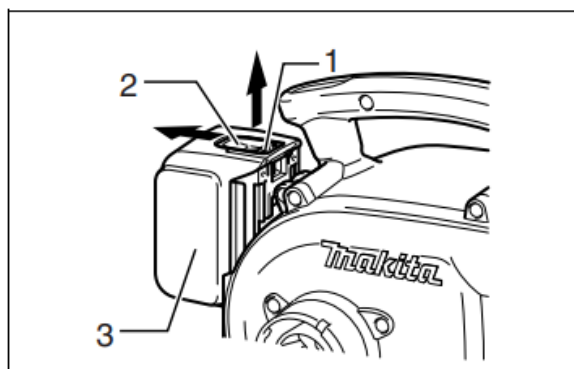

1 013850

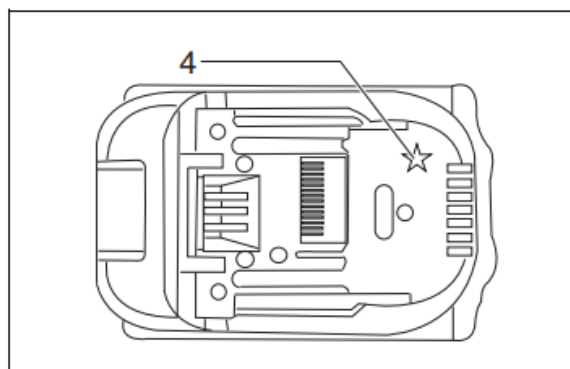

2 011389

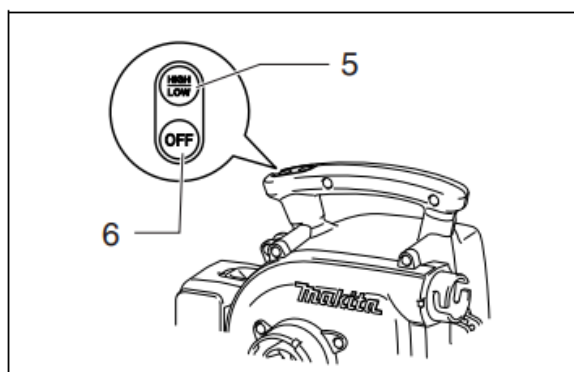

3 011121

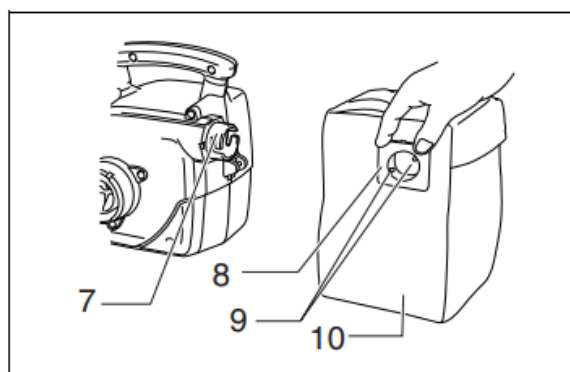

4 011113

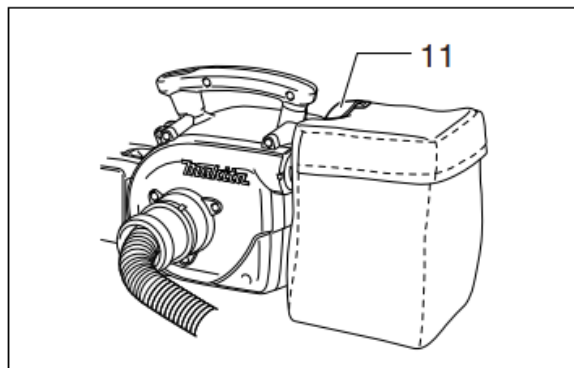

5 011114

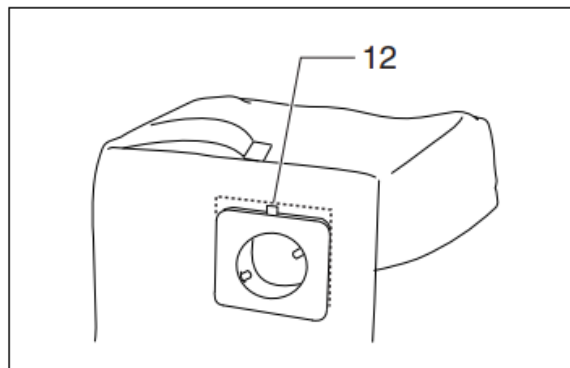

6 011115

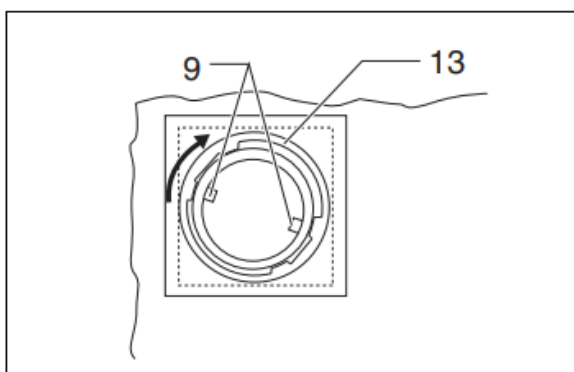

7 011116

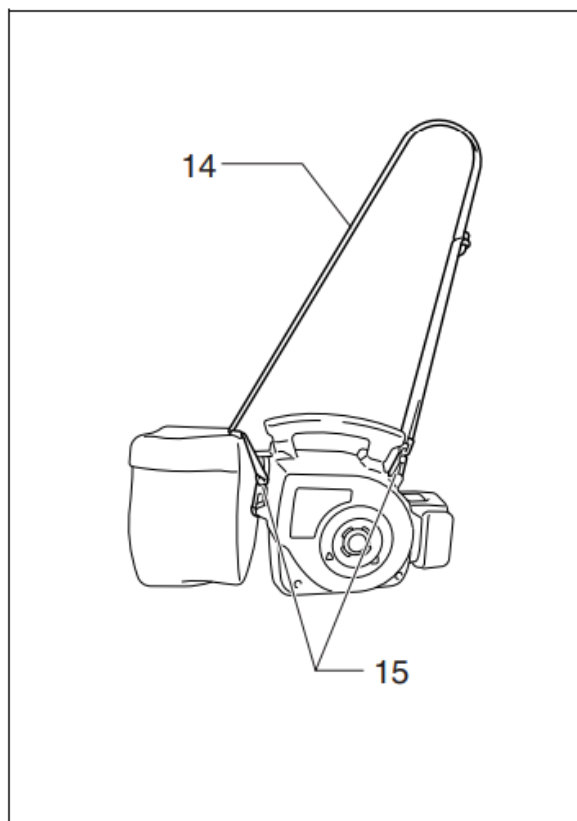

8

011117

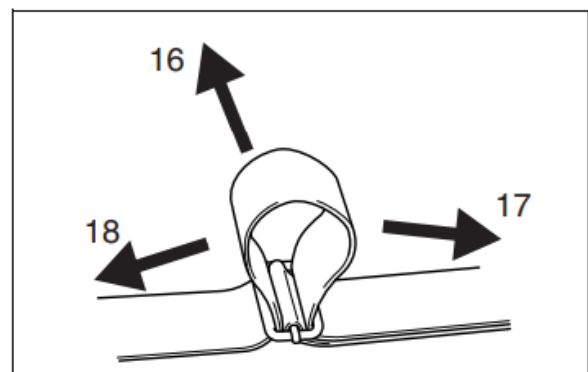

9

011118

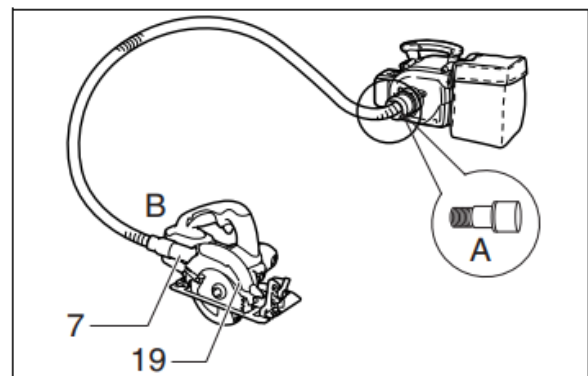

10

011119

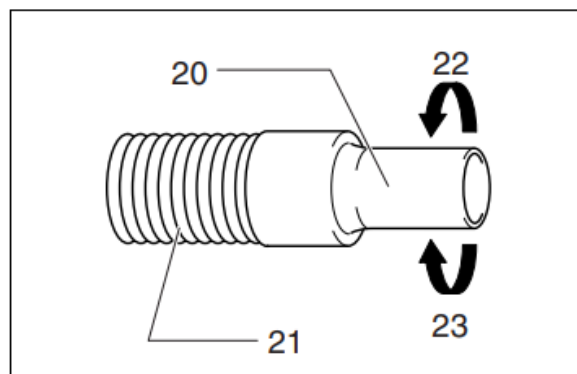

11

011120

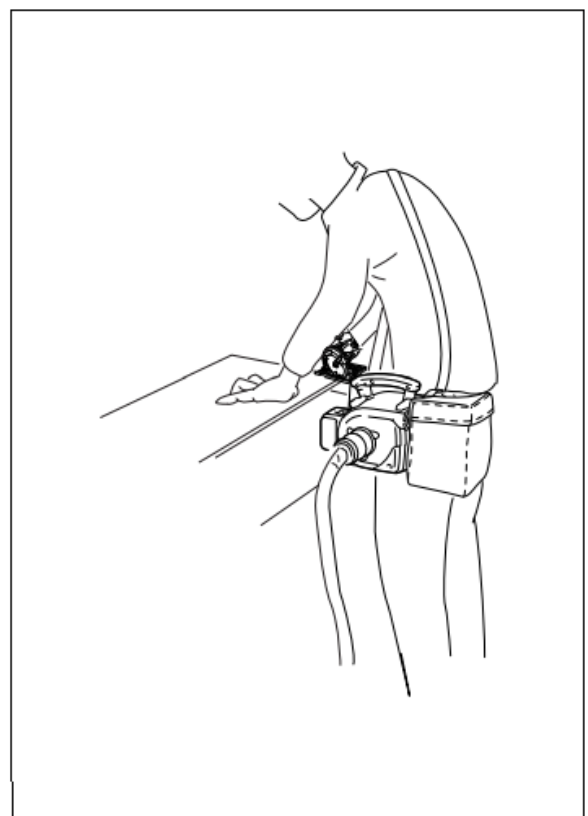

12

011122

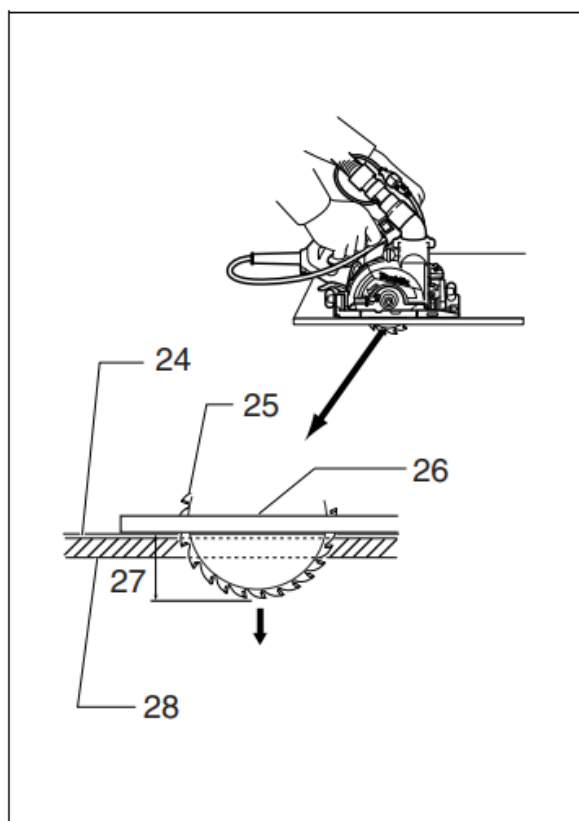

13

011123

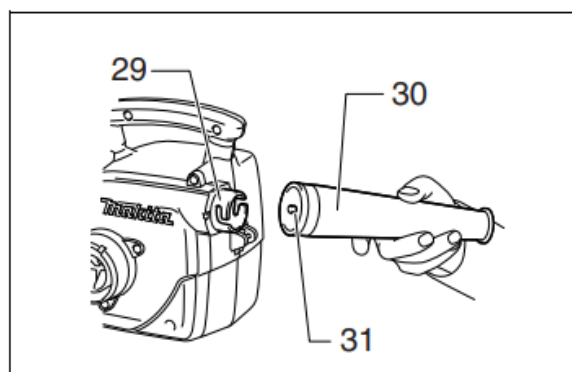

14

011124

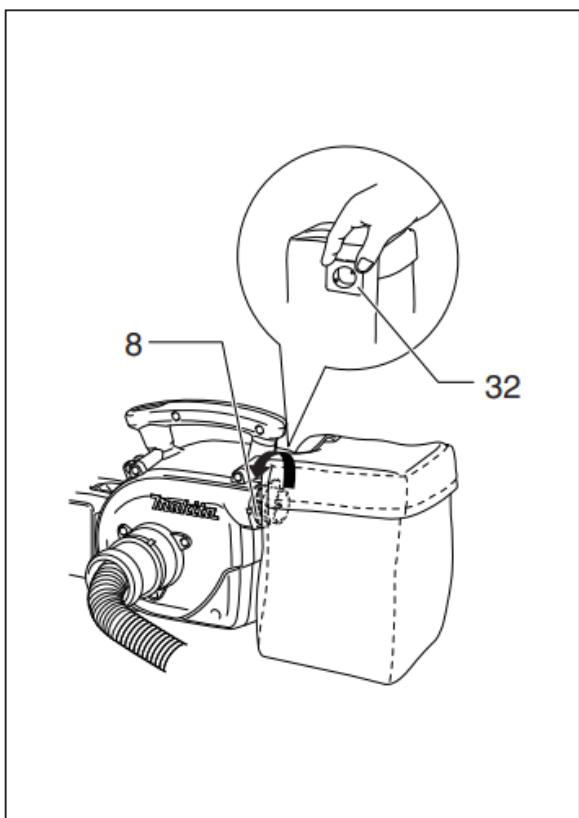

15

011125

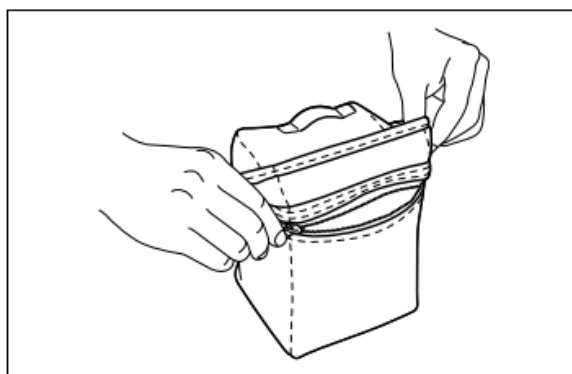

16

011126

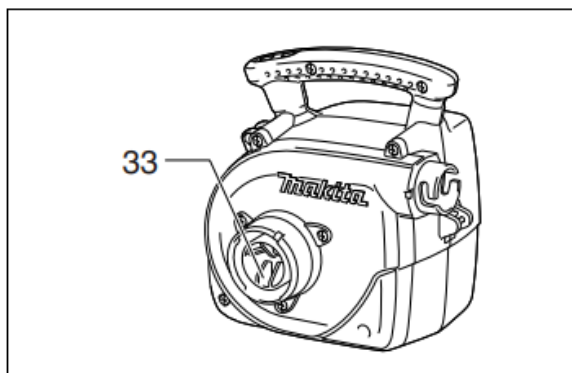

17

011127

ENGLISH (Original instructions)

WARNING: This appliance can be used by children aged from 8 years and above and persons with reduced physical, sensory or mental capabilities or lack of experience and knowledge if they have been given supervision or instruction concerning use of the appliance in a safe way and understand the hazards involved. Children shall not play with the appliance. Cleaning and user maintenance shall not be made by children without supervision.

Explanation of general view

1 Red indicator	12 Protrusion	23 Install
2 Button	13 Ring	24 Decorative paper
3 Battery cartridge	14 Shoulder strap	25 Saw blade
4 Star mark	15 Two hooks	26 Base
5 HIGH/LOW button	16 Pull out	27 Cutting depth
6 OFF button	17 For shortening	28 Plaster board
7 Dust outlet	18 For extending	29 Outlet (air vent)
8 Dust bag joint	19 Power tool	30 Nozzle
9 Pins	20 Front cuff	31 Pin
10 Dust bag	21 Hose	32 Square section
11 Hook	22 Remove	33 Filter area

SPECIFICATIONS

Model		DVC340	DVC350
Capacity	Volume	3.0 L	
	Max. Air volume	3.3 m ³ /min.	3.4 m ³ /min.
Continuous use (Approx.)	HIGH	4 min (with BL1415)	6 min (with BL1815)
		5 min (with BL1415N)	7 min (with BL1815N)
		—	8 min (with BL1820)
		10 min (with BL1430)	13 min (with BL1830)
		13 min (with BL1440)	18 min (with BL1840)
		—	21 min (with BL1850)
	LOW	8 min (with BL1415)	12 min (with BL1815)
		10 min (with BL1415N)	14 min (with BL1815N)
		—	16 min (with BL1820)
		20 min (with BL1430)	26 min (with BL1830)
		26 min (with BL1440)	36 min (with BL1840)
		—	42 min (with BL1850)
Overall length		403 mm	
Net weight		2.1 kg (BL1415/BL1415N)	2.2 kg (BL1815/BL1815N/BL1820)
		2.3 kg (BL1430/BL1440)	2.4 kg (BL1830/BL1840/BL1850)
Rated voltage		D.C. 14.4 V	D.C. 18 V

- Due to our continuing program of research and development, the specifications herein are subject to change without notice.
- Specifications and battery cartridge may differ from country to country.
- Weight, with battery cartridge, according to EPTA-Procedure 01/2003

Intended use

The tool is intended for collecting dry dust.

ENE017-1

GEA010-1

General Power Tool Safety Warnings

⚠ WARNING Read all safety warnings and all instructions. Failure to follow the warnings and instructions may result in electric shock, fire and/or serious injury.

Save all warnings and instructions for future reference.

ENB117-4

**CORDLESS VACUUM CLEANER
SAFETY WARNINGS**

⚠ WARNING! IMPORTANT READ CAREFULLY all safety warnings and all instructions **BEFORE USE**. Failure to follow the warnings and instructions may result in electric shock, fire and/or serious injury.

1. Operators must be adequately instructed on the use of this cleaner.
2. This cleaner is not suitable for picking up hazardous dust.
3. This cleaner is for dry use only.
4. This cleaner is for indoor use only.
5. This cleaner shall be stored indoors only.
6. Do not pick up the following materials:
 - Hot materials such as lit cigarettes or spark/metal dust generated by grinding/cutting metal
 - Flammable materials such as gasoline, thinner, benzene, kerosene or paint
 - Explosive materials like nitroglycerin
 - Ignitable materials such as Aluminum, zinc, magnesium, titanium, phosphorus or celluloid
 - Wet dirt, water, oil or the like
 - Hard pieces with sharp edges, such as wood chips, metals, stones, glasses, nails, pins or razors
 - Powder to clot such as cement or toner
 - Conductive dust such as metal or carbon
 - Fine particle like concrete dustSuch action may cause fire, injury and/or property damage.
7. Stop operation immediately if you notice anything abnormal.
8. Do not bring close to stoves or other heat sources.
9. Do not block the intake hole or vent holes.
10. Do not leave the cleaner when battery fitted. Remove battery from appliance when not in use and before servicing.
11. Do not allow to be used as a toy. Close attention is necessary when used by or near children.
12. Use only as described in this manual. Use only manufacturer's recommended attachments.
13. Do not put any object into openings. Do not use with any opening blocked; keep free of dust, lint, hair, and anything that may reduce air flow.
14. Use extra care when cleaning on stairs.
15. When using the cleaner as a blower

- always use protective goggles, a cap and mask while operating;
- always be sure that the cleaner is switched off and the battery cartridge is removed before clearing a blockage;
- always be sure of your footing on slopes;
- walk, never run;
- never point the nozzle at anyone in the vicinity;
- Keep all nuts, bolts and screws tight to be sure the cleaner is in safe working condition;
- Store the cleaner only in a dry place;
- The operator or user is responsible for accidents or hazards occurring to other people or their property.

KEEP FOR FUTURE REFERENCE**⚠ WARNING:**

DO NOT let comfort or familiarity with product (gained from repeated use) replace strict adherence to safety rules for the subject product. MISUSE or failure to follow the safety rules stated in this instruction manual may cause serious personal injury.

This cleaner is intended for both domestic and commercial use, for example in hotels, schools, hospitals, factories, shops, offices and rental businesses.

ENC007-8

IMPORTANT SAFETY INSTRUCTIONS**FOR BATTERY CARTRIDGE**

1. Before using battery cartridge, read all instructions and cautionary markings on (1) battery charger, (2) battery, and (3) product using battery.
2. Do not disassemble battery cartridge.
3. If operating time has become excessively shorter, stop operating immediately. It may result in a risk of overheating, possible burns and even an explosion.
4. If electrolyte gets into your eyes, rinse them out with clear water and seek medical attention right away. It may result in loss of your eyesight.
5. Do not short the battery cartridge:
 - (1) Do not touch the terminals with any conductive material.
 - (2) Avoid storing battery cartridge in a container with other metal objects such as nails, coins,
 - (3) Do not expose battery cartridge to water or rain.A battery short can cause a large current flow, overheating, possible burns and even a breakdown.
6. Do not store the tool and battery cartridge in locations where the temperature may reach or exceed 50°C (122°F).
7. Do not incinerate the battery cartridge even if it is severely damaged or is completely worn out. The battery cartridge can explode in a fire.
8. Be careful not to drop or strike battery.
9. Do not use a damaged battery.
10. Follow your local regulations relating to disposal of battery.

SAVE THESE INSTRUCTIONS.

Tips for maintaining maximum battery life

1. **Charge the battery cartridge before completely discharged.**
Always stop tool operation and charge the battery cartridge when you notice less tool power.
2. **Never recharge a fully charged battery cartridge.**
Overcharging shortens the battery service life.
3. **Charge the battery cartridge with room temperature at 10°C – 40°C (50°F – 104°F).** Let a hot battery cartridge cool down before charging it.
4. **Charge the battery cartridge once in every six months if you do not use it for a long period of time.**

FUNCTIONAL DESCRIPTION

⚠ CAUTION:

- Always be sure that the cleaner is switched off and the battery cartridge is removed before adjusting or checking function on the cleaner.

Installing or removing battery cartridge (Fig. 1)

⚠ CAUTION:

- Always switch off the cleaner before installing or removing of the battery cartridge.
- **Hold the cleaner and the battery cartridge firmly when installing or removing battery cartridge.** Failure to hold the cleaner and the battery cartridge firmly may cause them to slip off your hands and result in damage to the cleaner and battery cartridge and a personal injury.

To remove the battery cartridge, slide it from the cleaner while sliding the button on the front of the cartridge.

To install the battery cartridge, align the tongue on the battery cartridge with the groove in the housing and slip it into place. Insert it all the way until it locks in place with a little click. If you can see the red indicator on the upper side of the button, it is not locked completely.

⚠ CAUTION:

- Always install the battery cartridge fully until the red indicator cannot be seen. If not, it may accidentally fall out of the cleaner, causing injury to you or someone around you.
- Do not install the battery cartridge forcibly. If the cartridge does not slide in easily, it is not being inserted correctly.

Battery protection system

The cleaner is equipped with the protection system, which automatically cuts off the output power for its long service life.

The cleaner stops during operation when the cleaner and/or battery are placed under the following situation. This is caused by the activation of protection system and does not show the cleaner trouble.

- When the cleaner is overloaded:
At this time, press the "OFF" button and remove causes of overload and then press the "HIGH/LOW" button again to restart.
- When battery cells get hot: (refer to the note below.)
If any operation of the "HIGH/LOW" button and the "OFF" button, the motor will remain stopped. At this time, stop use of the cleaner and cool or charge the battery cartridge after removing it from the cleaner.

- When the remaining battery capacity gets low:
If any operation of the "HIGH/LOW" button and the "OFF" button, the motor will remain stopped. At this time, remove the battery cartridge from the cleaner and charge it.

NOTE:

- This temperature-sensitive protection is applied only when the cleaner is used with a battery cartridge with a star mark. (Fig. 2)

Switch action (Fig. 3)

To start the cleaner, simply press the "HIGH/LOW" button. To switch off, press the "OFF" button. To change the cleaner speed, press the "HIGH/LOW" button. The first press on this button is for high speed and the second press for low speed and then each press on this button repeats the high/low speed cycle alternatively.

ASSEMBLY

⚠ CAUTION:

- Always be sure that the cleaner is switched off and the battery cartridge is removed before carrying out any work on the cleaner.
- Any work with the battery cartridge being installed on the cleaner may cause a personal injury or damage to the objects around the cleaner.

Installing dust bag (Fig. 4, 5, 6 & 7)

Hold the square section of the dust bag joint and fit the pins inside the dust bag joint to the notches in the dust outlet of the cleaner and then insert and turn it clockwise all the way until it stops.

At this time, make sure that the fastener part on the dust bag faces upward.

NOTE:

- When the dust bag joint and the ring inside the dust bag come off, install as follows.
 - (1) Align the dust bag joint with the seam of the dust bag and install it so that its protrusion faces upward.
 - (2) Tighten the ring inside the dust bag firmly so that the pins and the ring are positioned as shown in the figure.

Connecting the hose (Fig. 10)

⚠ CAUTION:

- **Do not force the hose to bend it and/or stamp it.** Forcing and/or stamping the hose may cause deformation or damage to the hose.
- **Do not pull the hose to carry the cleaner.** Pulling the hose may cause deformation or damage to the hose.

Insert the "A" end of the hose to the suction opening of the cleaner and turn it clockwise all the way until it locks. Attach the cuff on the "B" end of the hose and then connect it to the dust outlet of an power tool.

Replacing the front cuff (Fig. 11)

Change the front cuff of the hose according to the dust outlet size of a power tool you use.

To remove the front cuff, hold the hose and turn it counterclockwise.

To mount the front cuff, turn it clockwise and then screw it in until it stops.

OPERATION**⚠ WARNING:**

- Do not use the shoulder strap when working in a high place.
- When using the cleaner as a stationary cleaner, place it on a flat and stable surface.

Vacuum cleaner (Fig. 12 & 13)

When using the cleaner as a portable cleaner, cross-hanging the shoulder strap before the breast is difficult to drop the cleaner.

NOTE:

- Long cut-off decorative paper that may be produced by plaster board cutting work depending on the conditions of workpiece to be cut and that may be stuffed inside the hose may cause the hose suction blocking. When this occurs, change the cutting depth setting of power tool to deeper depth, which will relieve the hose suction blocking.

⚠ CAUTION:

- When the dust bag is just new, dust may come out of its surface. Using it a few times will minimize the dust leak from the surface.

Operation of the cleaner with a nozzle or a dust bag being installed**⚠ WARNING:**

- **Always be sure that the cleaner is switched off and the battery cartridge is removed before installing or removing the nozzle or any other attachment on the cleaner.** Failure to switch off and remove the battery cartridge may result in serious personal injury.

NOTE:

- Before the blower mode operation immediately after the cleaner mode operation, remove all remaining dust from the cleaner due to possible blow out of dust.

Using as a blower (Fig. 14)

Install the nozzle onto the outlet (air vent) without fail.

To install the nozzle, fit the pin protruding from the inside of nozzle to one of the cleaner notches and then turn the nozzle clockwise securely.

To remove the nozzle, turn counterclockwise and pull it out.

Direct the top point of the cleaner and then switch on.

Emptying the dust bag**⚠ WARNING:**

- **Always be sure that both the cleaner and a connected power tool are switched off and the battery cartridge is removed and the power tool, if corded tool, is unplugged before installing or removing the dust bag on the cleaner and emptying the dust bag (made of cloth).** Failure to switch off, remove the battery cartridge and unplug the connected power tool may result in electric shock and serious personal injury.
- When the dust bag is about half full, remove the dust bag from the cleaner and pull the fastener out. Empty the dust bag of its contents, tapping it lightly so as to remove particles adhering to the insides which might hamper further collection.

NOTE:

- **For the time to empty the dust bag, use a guide line that the dust bag becomes full when drilling about 450 holes with 6.5 mm diameter and 40 mm depth on the concrete.** A dust bag clogged with the built up particles may reduce the dust collection power and cause damage to the cleaner motor.

⚠ CAUTION:

- **Attach the dust bag (made of cloth) to the dust bag joint securely and close the fastener completely before use.** Failure to attach the dust bag securely and close its fastener completely may cause blow-out of dust and result in serious personal injury.

Pick up the square section of the dust bag joint firmly, turn it counterclockwise and then remove the dust bag.

(Fig. 15)

Open the fastener and dispose of the dust. (Fig. 16)

⚠ CAUTION:

- Remove all particles adhering to the fastener area.

MAINTENANCE**⚠ WARNING:**

- Always be sure that the cleaner is switched off and the battery cartridge is removed before attempting to perform inspection or maintenance.

Cleaning the filter area (Fig. 17)**⚠ CAUTION:**

- Do not pick up materials other than dust, such as stone, wood chip and the like since this cleaner is intended for dust collection. Picking up stone, wood chip and the like may cause damage to the fan and the cleaner.

Check and clean up the filter area in the suction inlet regularly. Remove foreign objects which will obstruct suction.

Cleaning

From time to time wipe off the outside (cleaner body) of the cleaner using a cloth dampened in soapy water.

⚠ CAUTION:

- Never use gasoline, benzene, thinner, alcohol or the like. Discoloration, deformation or cracks may result.

To maintain product SAFETY and RELIABILITY, repairs, any other maintenance or adjustment should be performed by Makita Authorized Service Centers, always using Makita replacement parts.

ENG900-1

Vibration

The vibration total value (tri-axial vector sum) determined according to EN60745:

- Work mode: operation without load
- Vibration emission (a_h): 2.5 m/s² or less
- Uncertainty (K): 1.5 m/s²

ENG901-1

- The declared vibration emission value has been measured in accordance with the standard test method and may be used for comparing one tool with another.
- The declared vibration emission value may also be used in a preliminary assessment of exposure.

⚠ WARNING:

- The vibration emission during actual use of the power tool can differ from the declared emission value depending on the ways in which the tool is used.
- Be sure to identify safety measures to protect the operator that are based on an estimation of exposure in the actual conditions of use (taking account of all parts of the operating cycle such as the times when the tool is switched off and when it is running idle in addition to the trigger time).

OPTIONAL ACCESSORIES**⚠ CAUTION:**

- These accessories or attachments are recommended for use with your Makita cleaner specified in this manual. The use of any other accessories or attachments might present a risk of injury to persons. Only use accessory or attachment for its stated purpose.

If you need any assistance for more details regarding these accessories, ask your local Makita Service Center.

- Nozzles
- Dust bags
- Hoses
- Front cuffs
- Shoulder straps
- Makita genuine battery and charger

NOTE:

- Some items in the list may be included in the tool package as standard accessories. They may differ from country to country.

ENG905-1

Noise

The typical A-weighted noise level determined according to EN60745:

Model DVC340

- Sound pressure level (L_{pA}): 81 dB (A)
- Sound power level (L_{WA}): 92 dB (A)
- Uncertainty (K): 3 dB (A)

Model DVC350

- Sound pressure level (L_{pA}): 84 dB (A)
- Sound power level (L_{WA}): 95 dB (A)
- Uncertainty (K): 3 dB (A)

Wear ear protection